



Sensonic D-2

CHARACTERISTIC | FEATURES | TECHNICAL DATA | APPEARANCE

Sensonic D-2 is a powerful gas conditioner necessary to prepare gas sample before further analysis. It removes most particles from the gas and keeps stable level of its humidity during whole measurements.

Sensonic D-2

CHARACTERISTIC FEATURES TECHNICAL DATA APPEARANCE

- Gas conditioner unit includes:
 - Gas probe pipe of wide range of available lengths and types
 - Initial heated filter
 - Heated hose with integrated heated filter
 - LCD for checking the status of the gas dryer
 - Final filters that cleans the dried gas sample
 - Built-in gas pump for independent extraction of the gas sample
 - Peristaltic pump which removes condensated water (only if at least one Peltier element is installed)
 - Integrated solenoid valve for ventilation (works only with Sensonic IR-1 gas analyser)
- Powerful gas drying modules - Peltier element or / and Nafion® exchanger based (one or two drying modules)
- Remote control over RS232 from measurement unit (works only with Sensonic IR-1 gas analyser)



Sensonic D-2



CHARACTERISTIC

FEATURES

TECHNICAL DATA

APPEARANCE

SENSONIC D-2 GAS DRYER WITH SINGLE CONDENSATION DRYER

Dimensions (W * H * D)	500 mm * 340 mm * 150 mm
Weight	12 kg ÷ 13 kg
Casing material	Plywood covered with aluminium
Operating conditions	T: 10°C ÷ 50°C, RH: 5% ÷ 90% (non-condensing)
Dryer type	Based on Peltier cooling element with fan (12V DC supply)
Drying method	Water condensation by rapid cooling down
Cooling temperature	0°C ÷ 20°C
Ready to operate after	5 minutes
Storing temperature	0°C ÷ 60°C
Maximum gas flow for efficient drying (at inlet gas temp. 100°C and RH 100%)	100 l/h
Gas filters: quantity material	2 PA - body, PC - cover, viton - sealing
Filter insert: length ID OD material pore size	32mm 12mm or 15mm 18mm or 20mm PE 5µm
Condensate removal	With built-in peristaltic pump
Peristaltic pump capacity	38 ml/min
Power supply: input maximal power consumption	230V AC 40W (without heated hose)
Heated hose temperature	+180°C electronically stabilised
Heated hose temperature hysteresis	~5°C
Heated hose length	3m (optionally 5m or 10m)
Heated hose power supply: input maximal power consumption	230V AC 1000W
Heated hose thermocouple wires	K-type (S-type optionally)

Sensonic D-2

CHARACTERISTIC

FEATURES

TECHNICAL DATA

APPEARANCE

SENSONIC D-2 GAS DRYER WITH SINGLE NAFION® DRYER

Weight	9kg ÷ 10kg
Dryer type	Based on Nafion® exchanger
Drying method	Water transfer through Nafion® membrane driven by partial vapour pressure differential - first order kinetic reaction
Cooling temperature	n/a
Ready to operate after	1 minute
Under pressure in Nafion® collar	~ 500 mbar

*all other data is the same as for Sensonic D-2 gas dryer with single condensation dryer

SENCONIC D-2 GAS DRYER WITH NAFION® DRYER + CONDENSATION DRYER

Weight	11 kg ÷ 12 kg
Dryer type	Outlet 1: Based on Nafion® exchanger Outlet 2: Based on Peltier cooling element with fan (12V DC supply)
Drying method	Outlet 1: Water transfer through Nafion® membrane driven by partial vapour pressure differential - first order kinetic reaction Outlet 2: Water condensation by rapid cooling down
Cooling temperature	Outlet 1: n/a Outlet 2: 0°C ÷ 20°C

Ready to operate after 10 - 15 minutes

*all other data is the same as for Sensonic D-2 gas dryer with single condensation dryer

SENSONIC D-2 GAS DRYER WITH DUAL CONDENSATION DRYER

Weight	12 kg ÷ 13 kg
Cooling temperature	First dryer: Constant, about +1°C, output gas dewpoint about +4°C Second dryer: 0°C ÷ 20°C
Ready to operate after	10 - 15 minutes

*all other data is the same as for Sensonic D-2 gas dryer with single condensation dryer

Sensonic D-2

CHARACTERISTIC | FEATURES | TECHNICAL DATA | APPEARANCE

FRONT PANEL

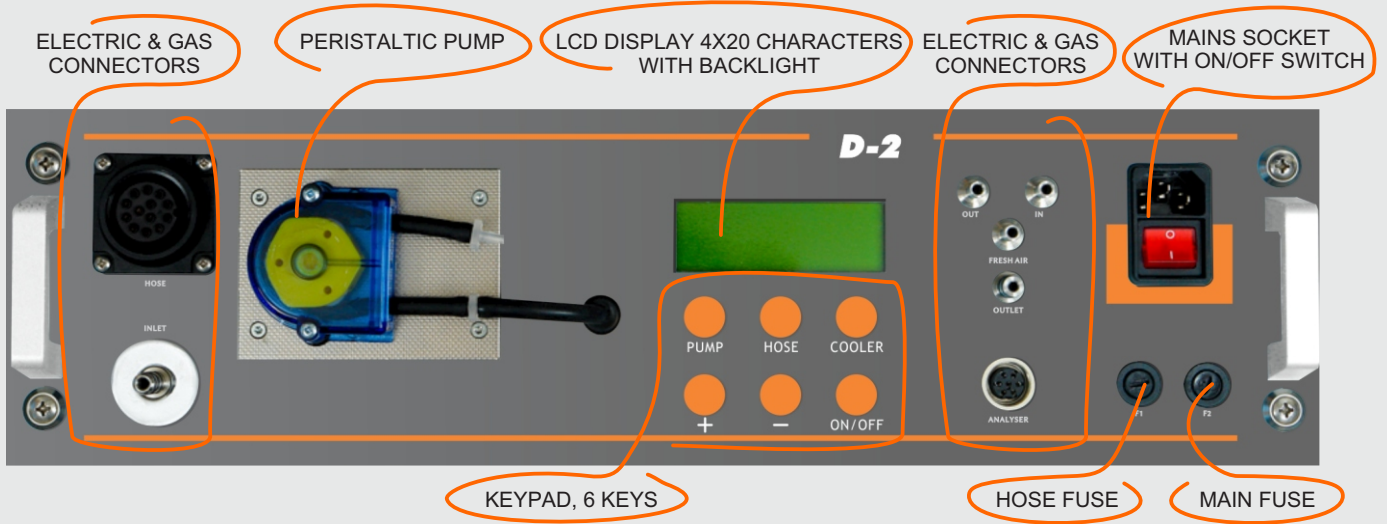

GAS AND ELECTRONIC CONNECTORS

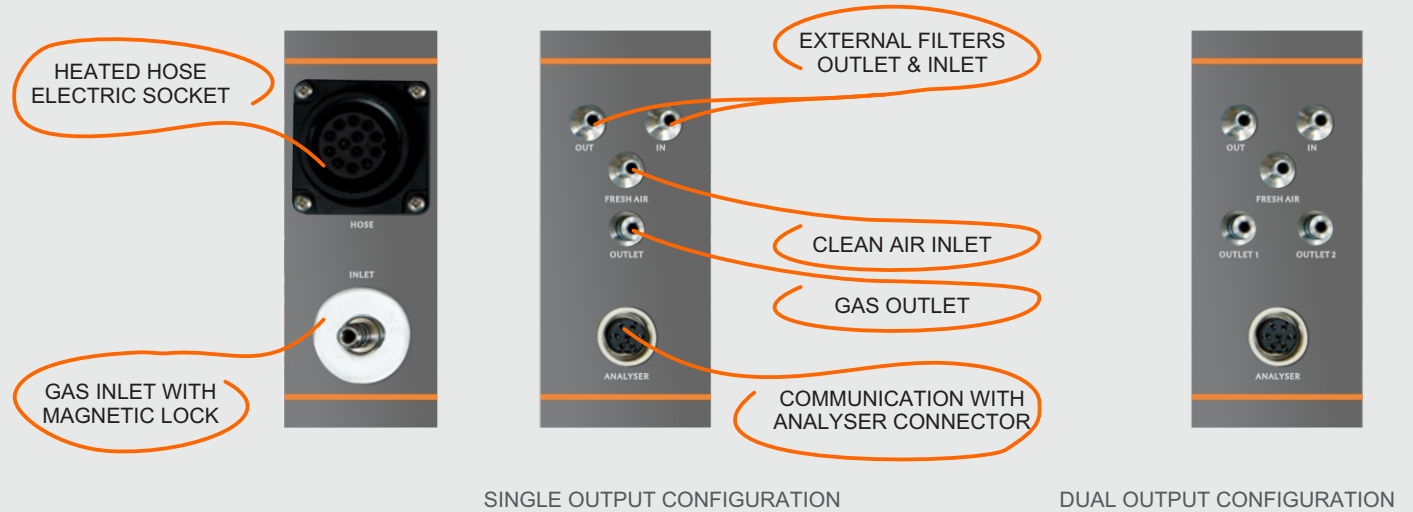

EXAMPLE PRINT SCREENS

